

Ref.	Part No.	Description	Ref.	Part No.	Description	Ref.	Part No.	Description
1.	530071927	Kit- Trigger/Lockout	26.	530071966	Kit- EPS Starter Pulley	47.	545039501	Wheel-Bar Adjust
2.	545011903	Cover-Handle	27.	545011703	(Incl. 23,24,25, 32)	48.	530150000	Assy-Bar Adjust
3.	530016433	Screw	28.	545006108	Housing-Fan	49.	545157401	Pin-Bar Adjust
4.	530023877	Fitting-Fuel line	29.	530069232	Handle-Starter	50.	545147001	Clip-Spring
5.	530069216	Kit-Fuel Line (Large)	30.	530016432	Kit-Rope	51.	530016439	Screw
6.	530069247	Kit-Fuel Line (Small)	31.	530042095	Screw	52.	530014381	Kit-Spike (incl. 51)
7.	530095646	Assy-Fuel Pick Up	32.	530042095	Spring-Starter	53.	952051211	Chain 16"
8.	545012103	Handle-Rear	33.	530016080	Screw	54.	545084101	Bar 16"
9.	530059475	Spring-Rear Isolator	34.	530057868	Baffle	55.	530016432	Screw
10.	530071945	Kit-Clutch Washer	35.	530057886	Assy-Oil Vent	56.	530016443	Screw
11.	530057905	Assy-Clutch Drum 3/8"	36.	530057236	Assy-Oil Cap w/ret.	57.	530059480	Assy-Rear Iso. Spring
12.	530071945	Kit-Clutch Washer	37.	530057880	Handguard	58.	530015906	Screw
13.	530057907	Assy-Clutch	38.	530016416	Spring-Handguard	59.	530059479	Assy-Front Iso. Spring
14.	530016419	Washer-Large Clutch	39.	545011813	Assy-Chassis (Incl. 4,5,6,7,9,15,16,17,18, 20,34,35,37,41,59,)	60.	530057878	Handle-Front
15.	530015906	Screw	40.	530071893	Kit-Chainbrake	61.	530016432	Screw
16.	530047192	Assy-Fuel Cap w/ret	41.	530016432	Screw	62.	530071945	Kit-Clutch Washer
17.	530016064	Screw	42.	530016133	Bolt-Bar	63.	530057924	Assy-Oil Pick Up
18.	530015922	Nut-"U" type speed	43.	530057910	Plate-Bar	64.	530071891	Kit-Oil Pump
19.	530039231	Assy-Flywheel	44.	530016064	Screw	65.	530016064	Screw
20.	530057911	Shield-Heat	45.	530059999	Cover-Gearbox	66.	530057931	Assy-Oil Pump
21.	530015127	Washer-Flywheel	46.	545040601	Knob	67.	530037820	Gear-Worm
22.	530016134	Nut-Flywheel	47.	545027903	Assy-Clutch Cover			
23.	530021179	Screw-Shoulder						
24.	530059677	Starter Hub-EPS						
25.	530021180	Spring-EPS						

↙ = NEW PART NUMBER FOR THIS IPL ★ = REFER TO THE SERVICE REFERENCE INDICATED FOR MORE INFORMATION. (LOCATED AT END OF IPL)

PARTS LIST NO. 545014370		Poulan PRO® PARTS LIST	CHAIN SAW MODEL(S) 3616
DATE 08/02/07	Replaces 545014370 – 03/07/07		Note: Illustration may differ from actual model due to design changes

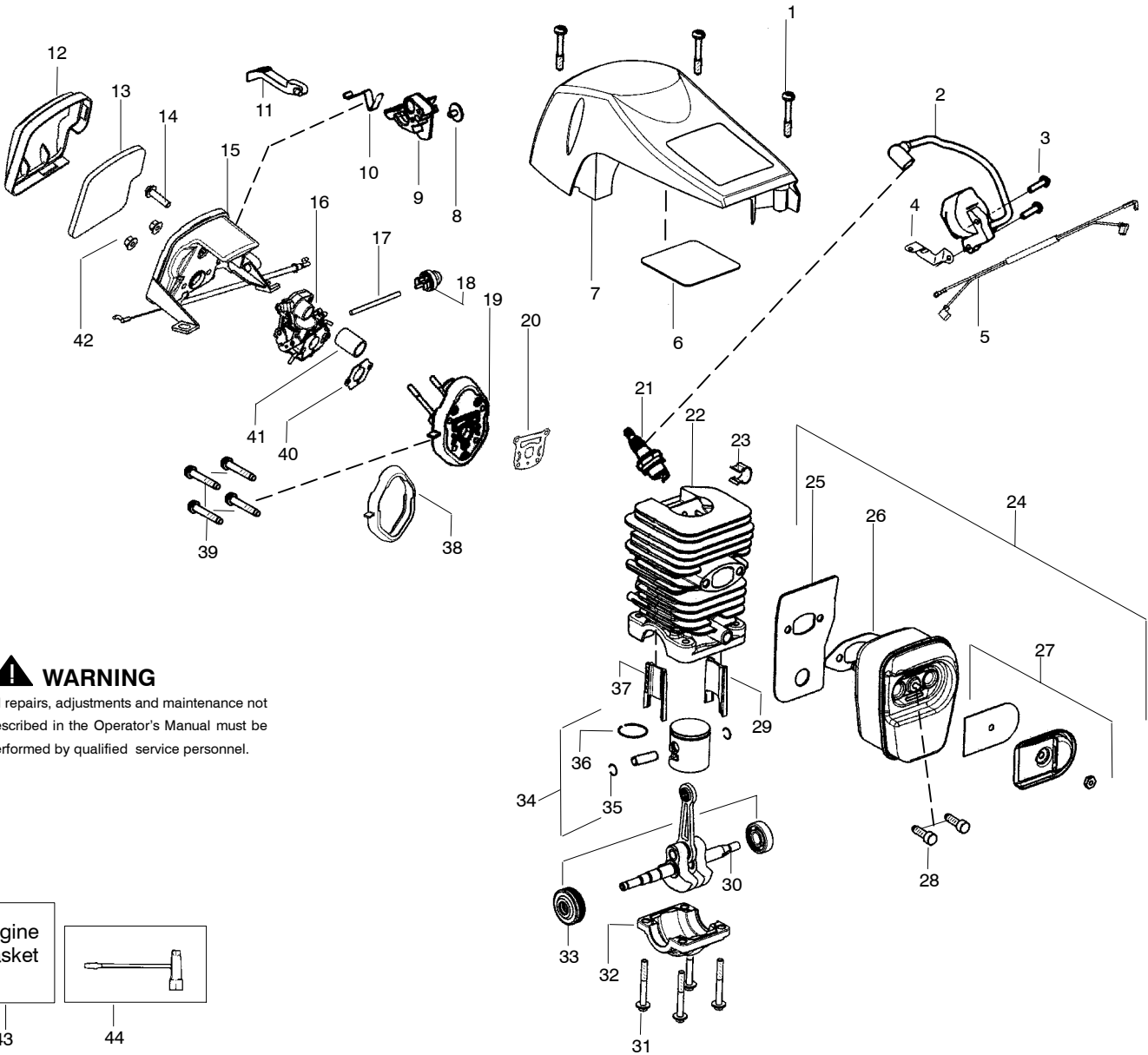

⚠ WARNING

All repairs, adjustments and maintenance not described in the Operator's Manual must be performed by qualified service personnel.

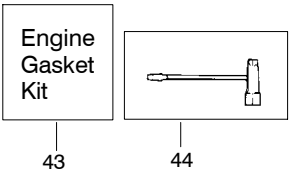

Ref.	Part No.	Description	Ref.	Part No.	Description	Ref.	Part No.	Description
1.	530016153	Screw	19.	530071889	Kit-Carb. Adaptor (Incl. # 20,38,41)	36.	530038729	Ring-Piston
2.	530039232	Module-Ignition	20.	530071894	Gasket-cyl. (kit)	37.	545015401	Insert-Right (gray)Cyl.
3.	530016432	Screw	21.	952030150	Accy-Spark Plug (RCJ-7Y)	38.	530071894	Seal-Adaptor (kit)
4.	530058661	Strap-Ground	22.	530071885	Kit-Cylinder (Incl. 29,37)	39.	530016426	Screw
5.	530057943	Assy-Wire Harness	23.	530058660	Clip-High Tension Lead	40.	530071894	Gasket-Carb. (kit)
6.	530055698	Reflector-Tape	24.	545081801	Kit-Muffler (Incl. 25,26,27,28)	41.	530057926	Tube-Intake
7.	530057872	Shield-Cylinder(Incl.1,6)	25.	530057942	Backplate-Muffler	42.	530016101	Nut-Carb.
8.	530016080	Screw	26.	530071894	Gasket-Muffler (kit)	43.	530071894	Kit-Gasket (Incl. 20,26,38,40)
9.	530057891	Lever-Ignition Switch	27.	545081701	Kit-Spark Arrestor	44.	530031135	Scrench
10.	530057908	Spring-Ignition Switch	28.	530016338	Bolt-Muffler			Not Shown
11.	530059399	Knob-Choke	29.	545015301	Insert-Left (black) Cyl.			
12.	530059001	Cover-Air Filter	30.	530012537	Assy-Crankshaft/Rod Bolt			
13.	530057869	Filter-Air	31.	530016417	Bolt			
14.	530016425	Screw	32.	530057941	Cap-Crankcase			
15.	545046901	Housing-Air Filter w/cable	33.	530056363	Assy-Bearing/Seal	545123806		Manual-Operator
16.	---	Carburetor	34.	530071882	Kit-Piston (Incl. 35,36)	545083603		Decal-Warning
17.	530069247	Kit-Fuel Line (Small)	35.	530015697	Retainer-Piston Pin			
18.	530047721	Bulb-Purge "snap-in"						

✓ = NEW PART NUMBER FOR THIS IPL * = REFER TO THE SERVICE REFERENCE INDICATED FOR MORE INFORMATION. (LOCATED AT END OF IPL)